

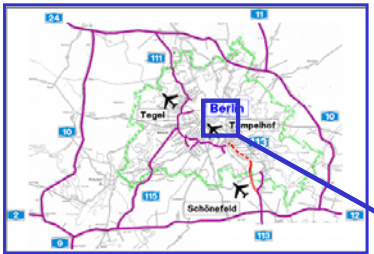

Planning services – all from one source

Our partners' spectacular projects

Berlin



Accessible via underground and tram from Friedrichstrasse

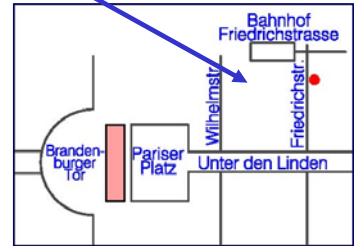

Friedrichstrasse 90
10 117 Berlin
Tel.: +41/79/551 74 52

Layout, Print: amf limited & Co. KG
www.amf-ltd.de
Flyeramf_Partner-11/2009

Office information

Our company, alpha management forum limited & Co. KG, is a German company based in Berlin. It was formed as a planning platform for the provision of planning services in Germany and abroad. We offer these planning services in structural and civil engineering, especially in complex construction co-ordination.

We proved our services in co-operation with other service providers. Our partners are from Germany, Austria, Switzerland and Russia. To strengthen our presence in Russia we have founded and based the ooo.amf Sibir in Russia, which is equipped with all necessary licences for the Russian economic area and our central contact for Russian partners, purchasers and offices.

Our employees and also our cooperative partners can look back on more than 20 years of experience in their main discipline.

For many years, all partners have been working together on very complicated schemes in changing co-operations. The following designs show an overview of our spectrum of services through the spectacular references of our partners and employees.

Young Dong rail tunnel, South Korea

The Young Dong rail tunnel is a 16.3 km long, single track helical tunnel and shall be used by electrical and diesel-driven trains.

Purchaser: Korea National Railroad

Total costs: approx. €175 million

Scope of services: preparation of the ventilation and safety concepts. Testing of alternative possibilities for the dilution of pollutants. Risk analysis for operational cases and occurrence cases.

Service period: 1999-2007



Loetschberg base tunnel, Los Nord, Switzerland

The 34.6 km long Loetschberg base tunnel for railway traffic is an essential part of the Alptransit concept and leads from Frutigen into Raron.

Purchaser: BLS Alptransit AG

Total costs: €2.700 million

Scope of services: Studies, concept planning, implementation planning, construction supervision for the construction elements.

Service period: 1999-2007

Waldschloeschen bridge, Dresden

This extremely controversial project has had to be changed considerably in the course of the implementation planning (streamlining) in order to achieve better integration into the Elbtal.

Purchaser: Regional capital: Dresden

Total costs: approx. €35 million

Scope of services: implementation planning

Service period: 2007-2009

Copyright Henry Ripke Architect



Interchange
Neukoelln



Connecting motorway A 113 (new) in Berlin

Town motorway approx. 10.5 km (6 lanes) with 19 bridges and 2 tunnels.

Purchaser: Berlin Senate

Total costs: €135 million

Scope of services: Project management from preliminary design until construction completion (personal reverence Dipl. Ing. Frank Ammerschuber as project manager)

Service period: 1993-2008

Space for the relocation of Behrenstrasse and Ebertstrasse on 18th March

In the area of the new American embassy, the adjacent roads Ebertstrasse and Behrenstrasse need to be shifted by approx. 15 m for safety reasons. In the public road area, safety locks and bollards must be integrated.

Purchaser: Berlin Senate (for road construction)
State Department (for safety installations)

Total costs: €5.8 million (incl. safety features and equipment)

Scope of services: Planning and tender incl. safety features and equipment in the public road area (personal reverence Dipl. Ing. Frank Ammerschuber as project manager)

Service period: 2003-2007



Infrastructure

- A Construction and project management
- B Motorways, urban roads
- C Engineering work, bridges
- D Complex development
- E Track and rail construction

We also cooperate with special services such as surveying, foundations, and traffic, noise and environmental expertise.

Federation Tower Moscow, Russia

The maximum height of the building is 506 m (east tower 360 m, west tower 243 m). The gross floor area is approx. 665,000 m².

Purchaser: Mirax Group
Total costs: approx. €500 million

Scope of services: Conception for building services (heating, ventilation, electrical engineering)

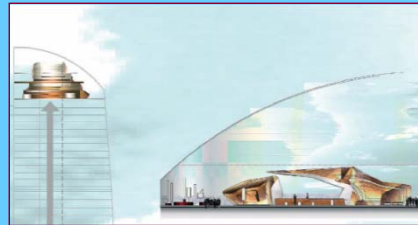

Building construction

- A Construction and project management
- B Architectural services
- C Support structure planning, statics
- D Heating, ventilation, sanitation
- E Electrical engineering, telecommunications

We also cooperate with special services such as fire protection, visualization and landscaping.



Grand Hyatt in Federation Tower Moscow, Russia

The 368 high class rooms of the Grand Hyatt are situated between the 49th and 61st floors, diverse bars and restaurants between the 91st and 94th floors and the lobby will be situated on the 91st floor.

Purchaser: Mirax Group
Total costs: approx. €500

Scope of services: Conception for the design of the interior design of the reception and rooms

Jin Mao Tower, Shanghai, China

At 421 m high and with 88 floors, the Jin Mao Tower is the second highest building in the Republic of China and the fifth highest skyscraper in the world. The first 50 floors shall be used as offices. On the upper 38 floors will be the 5 star Grand Hyatt Hotel with the 555 highest hotel rooms in the world. The floor space in Jin Mao Tower is approx. 279,000 m².

Purchaser: China Shanghai Foreign Trade Center

End of construction: 1998

Scope of services: Installation of cold, warm and central building control systems, ventilation facilities and an electricity supply.



Ahmad Al Attar Tower Dubai, United Arab Emirates

Ahmad Al Attar Tower Dubai is a high rise building with a height of 301 Meter up to the roof and an area of 30 x 30 m. The 76 floors are occupied by offices and a hotel.

Purchaser: Mr. Ahmad Abdul Rahim Ahmed Al Attar

Total height: 342 m

Scope of services: Structural design, investigation for different variants for the reinforcement system and foundation, statics and blueprint pile foundations

Service period: 2003-2004

Galaxy Erding, Germany

Within the domed building, a spectacular sliding system with about 16 slides has been built. Underneath there is body slides, hoop slides, wild water slides, high speed, kamikaze and ski jumps as well as, at 320 m, the longest slide in Europe. It is the biggest slide system in Europe and an integral part of the sauna, slide and thermal world in Europe.

Construction of the complete slide system

Service period: 1998-1999

